

EV charging stations-FIMER

Engineering, design,
procurement, bescom
approvals, power service
and commissioning of
**AC,DC ,fast charging,
solar powered EV
charging stations-FIMER-
SUNAP-MINCHU**

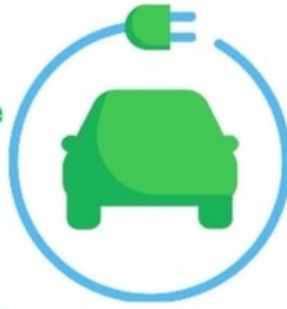

FIMER FLEXA
AC Wallbox
3.7 - 7.4
11 - 22 kW



FIMER FLEXA
AC Station
2 x 22 kW
1 x 3.7 kW + 1 x 22 kW



FIMER ELECTRA
DC Station
60 kW - 90 kW
120 kW - 150 kW



FIMER ELECTRA
DC Wallbox
25 kW
*Upcoming Product

7/24

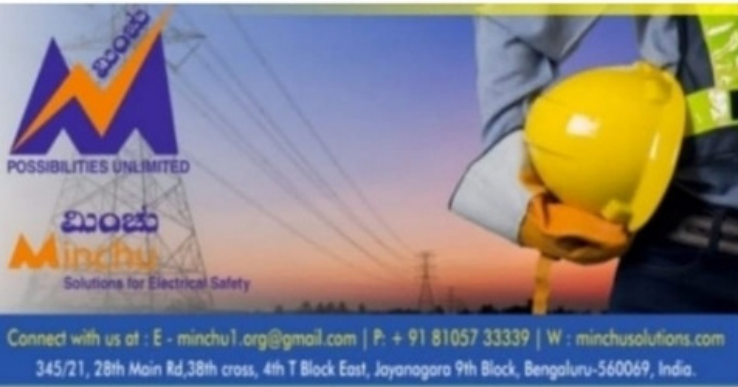

EVI General overview: AC & DC

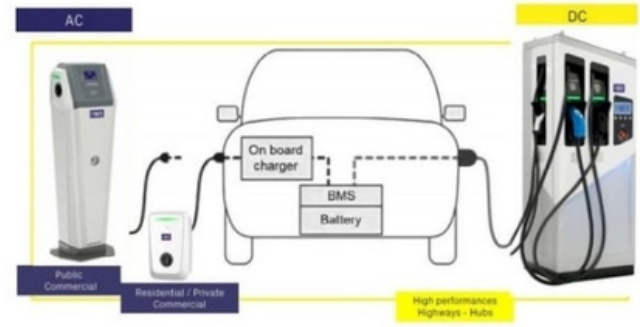

10 November 2021

FIMER FLEXA AC Wallbox & AC Station Product information



100% recycled material



- Multi-configuration: Master/Slave – Load manager
- Charging mode: Socket T2–Socket T3A–Cord T2
- Power output : 3,7 – 7,4 – 11 – 22 kW (AC Wallbox)
Power output : 3.7 & 22kW (AC Station)
- RFID Reader (Local White List)
- Wi-Fi – BLE – Ethernet – OCPP 1.6
- Protection level : IP55 and ANTITAMPER
- Easy installation and maintenance
- Private and public installation (on wall and stand)
- Power Backup : SuperCap Manager

14

Safety

- Automatic retention of the cable during charging
- Welding detection and intervention
- Diagnostic systems and internal coordination of protections
- Measurement of all internal tensions
- Monitoring of internal temperatures
- Monitoring of the status of the contactor and of the circuit-breaker
- Ground fault reclosure system
- Monitoring of electromechanical component status
- Leakage detect protection through Residual Current Device type B (or Type A + RCM)

Solid construction

- Full metal stainless steel exterior
- IK10 degree of mechanical strength at impact tests
- Strongly fixed to the ground
- External color provided with powder coating
- Optional base plate accessory available

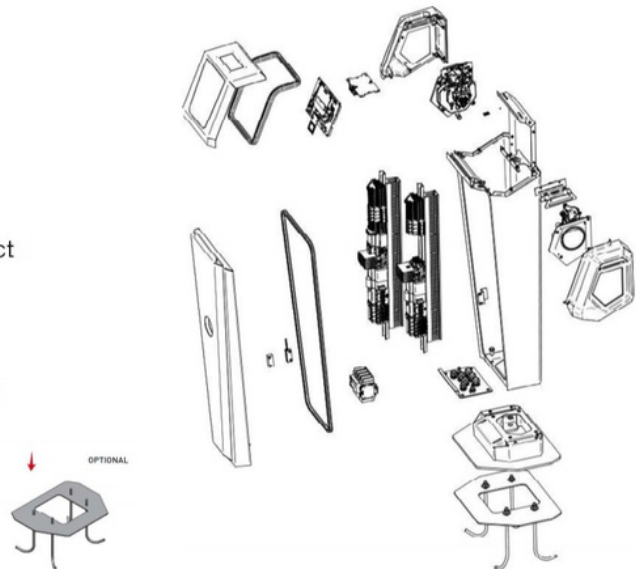

FIMER APP – FREE (by Bluetooth)

FIMER free app to allow a Bluetooth connection when in proximity (local only)



15

FIMER FLEXA AC Wallbox Interaction with solar inverter REACT 2

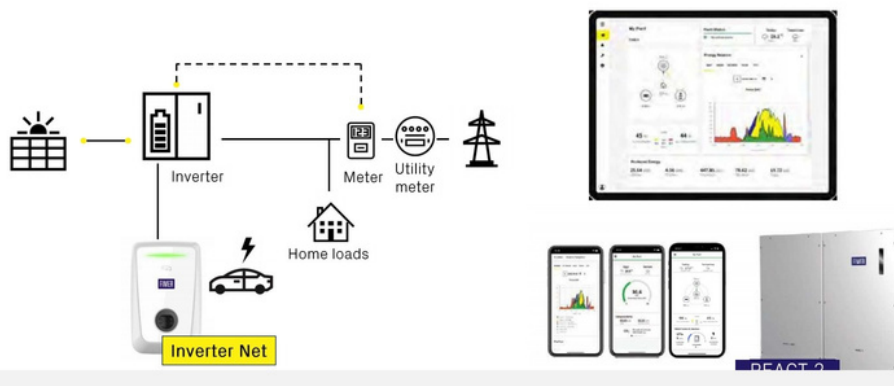

Connect to us for all you EV requirements

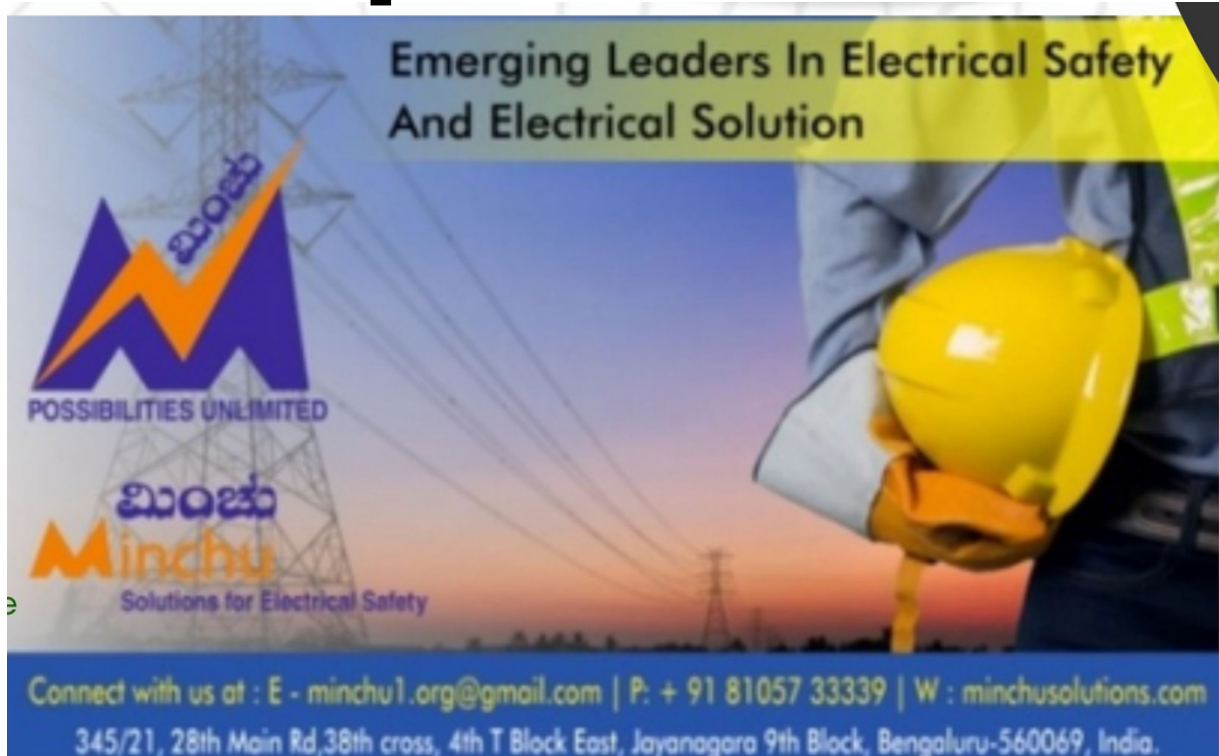

Emerging Leaders In Electrical Safety
And Electrical Solution

ಮಿಂಚು
POSSIBILITIES UNLIMITED
ಮಿಂಚು
Minchu
Solutions for Electrical Safety

Connect with us at : E - minchu1.org@gmail.com | P: + 91 81057 33339 | W : minchusolutions.com
345/21, 28th Main Rd, 38th cross, 4th T Block East, Jayanagara 9th Block, Bengaluru-560069, India.



ಮಿಂಚು
Minchu

PRANAV. C.M
C.E.O

8105733339
✉ minchu1.org@gmail.com
🌐 www.minchusolutions.com
📌 fb.me/minchu1.org
📍 #345/21, 38th Cross, 28th Main
9th Block, Jayanagar, Bangalore - 69

ಮಿಂಚು
Possibilities Unlimited

Solutions For Electrical Safety

Manufacturers :

Helmet Mounted Voltage Tester,
Pen Type Tester, Safety Switch Box,
Automatic Street Light Control, Solar Water Heaters,

Dealers In

Earthing Electrodes, Shock Proof Gloves, Telescopic Discharge Rods,
Safety Belt ,Safety Mask, Electrician Tools And Equipment, Safety Helmet ,
Solar Inverters, Solar Panels, ups and Inverters ,
Solar Water Heaters, Greysers, Led Light Fixtures (A.C./D.C.)

Services:

EPC And design In Lighting, Earthing and Solar, Electrical Repair
Services And Cable Works, Testing And Energy Auditing.